

-86°C ULTRA LOW FREEZER SOFUPSF-340 AC

INTERNAL FEATURES

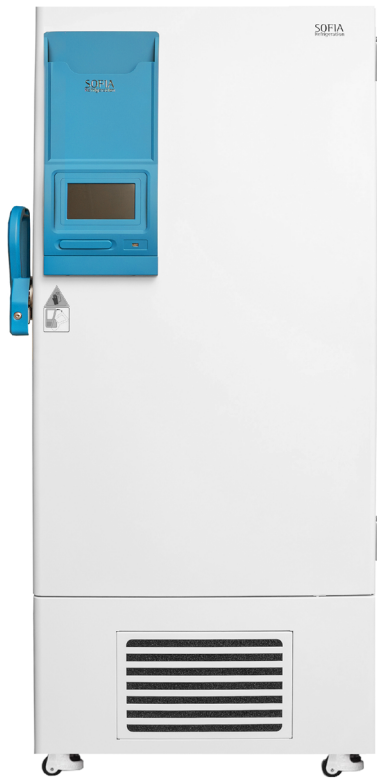

- HEAVY DUTY HINGES**
Guarantee 10 years of door body without deformation
- STEPPED DOOR FRAME DESIGN**
Reduce cold air leakage and ice build up
- LOCK THE COLD AIR**
Inner door closing pressure can be adjusted by the handle
- COMPLETE SS CHAMBER**
Robust stainless steel body for high sample safety and easy cleaning
- ENHANCED ADJUSTABLE SHELVES**
Stainless steel adjustable shelves that supports up to 50kg
- DOOR FRAME HEATING**
Effectively prevents ice build up
- ACCESS PORT**
For extra monitoring device
- KEEP THE COLD INSIDE**
Advanced internal VIP panels flexible and efficient silicone sealings firmly lock the cold air inside
- INNER DOOR GASKETS**
Low temperature resistance flexible silicone sealings reduce cold leakage
- VACUUM RELEASE PORT**
For quick re-access to samples
- COMPARTMENT DOORS**
Stainless steel and 27mm thick PU foam-filled inner doors for better insulation
- DETACHABLE DESIGN**
Inner doors can be easily removed and cleaned

TYPICAL PERFORMANCE CHARACTERISTICS IN 25°C AMBIENT

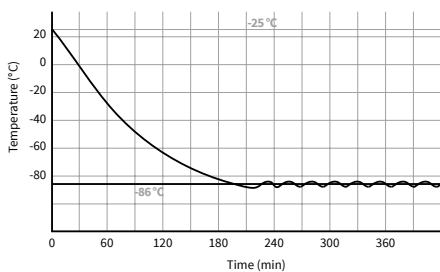

PULL DOWN TIMES

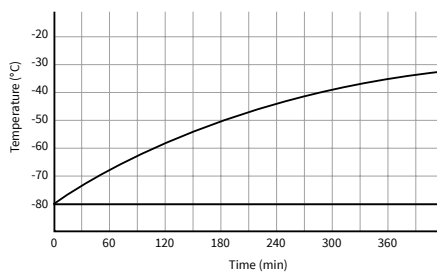

WARM UP TIMES

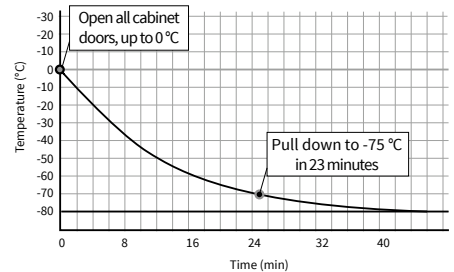

PERFECT RECOVERY TIME

Sofia Ref. LLC



Sales@sofiaref.com

SPECIFICATIONS

BASIC	
Stainless Steel Shelves Quantity	3
Cooling Method	Direct Cooling
Defrost	Manual
Temperature Range (°C)	-40~-86
Ambient temperature (°C)	10-32
Display	LED Digital
Access port QTY/ Diameter	1/ 25MM
USB Interface	Yes/ I
Remote Alarm Access	Yes/ I
Outside Material	Color Sprayed Steel
Inside Material	304 Stainless Steel
Castor Wheels	Included
Compartment Door	2
RS485 Access	Yes/ I
REFRIGERATION SYSTEM	
Refrigerant	R400 I (mixed gas)
Temperature Controller	Microprocessor
Cooling System	Auto-cascade
Sensor	PTC 100
Pull Down Time *(min)	224
Warm Up Time * (min)	205
Compressor brand/ QTY	SECOP / 2
Capacity (L/cu.ft)	340 / 12
Insulation	Vacuum Insulation Panel + Polyurethane Rigid Foam
Inner Door Material/ Quality	Foamed SS 304/2
Racks	12(4x4)
Boxes (2inches)	192
Sample (2ml)	19200
ELECTRICAL DATA	
Voltage/ Frequency (V/Hz)	220V / 50Hz or 60Hz
Power (W)	810
Current (A)	5.13
Power Consumption (kWh/24h)	13.09
Noise (db)	52
DIMENSIONS	
Package Size (WxDxH) mm	935 x 1070 x 2128
Exterior Size (WxDxH) mm	854 x 1072 x 1907
Interior Size (WxDxH) mm	488 x 607 x 1140
Shipping CBM	2.13
NW./GW/ (kg)	224.5/284.5
20GP/40GP/40HQ	12/24/24
ACCESSORIES	
Chart Recorder	Optional
Data Logger	Optional
CO2 Back Up System	Optional
LN2 Back UP System	Optional
ALARMS	
High / Low Temperature	
Power Failure	
Abnormal Voltage	
Sensor Error	
Filter Screen Check	
Thermostat Failure	
Low Battery	
Condenser Cleaning	
High Ambient Temperature	
Door Ajar	
Power failure backup system(alarm): 72hrs	

Sofia Ref. LLC



Sales@sofiaref.com

SHOP DRAWING

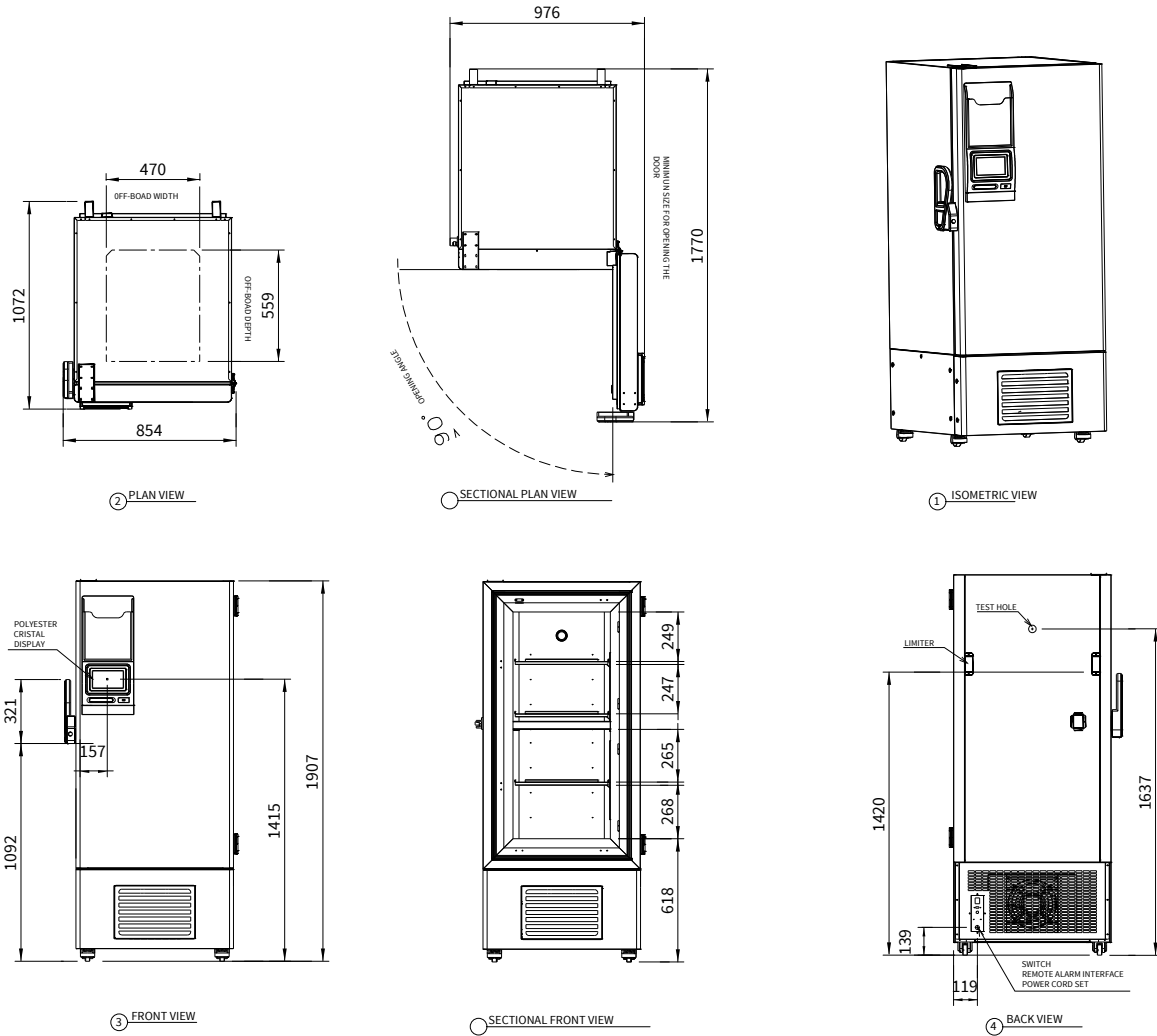

AUTO-CASCADE SYSTEM EXCHANGE CIRCULATION

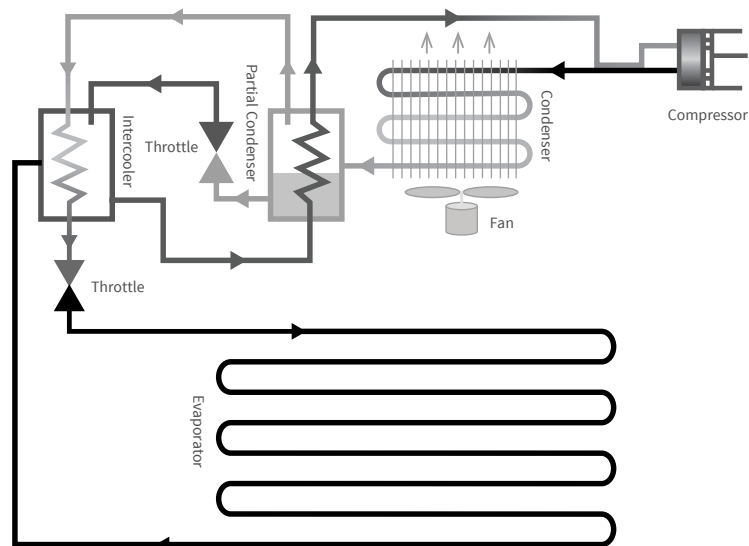

Sofia Ref. LLC



Sales@sofiaref.com